

1 FIFTH FLOOR PLAN
1:200

SCALE: 1:200
0 4m 8m 16m



PROJECT MANAGEMENT:
ARUP
South Lodge
South Parks Road
Oxford
Tel:
CIVIL ENGINEER AND STRUCTURAL ENGINEER:
RAMBOLL
Ramboll
240 Blackfriars Road
London SE1 8NW
Tel: 020 7631 5291

CLIENT:
UNIVERSITY OF OXFORD
University of Oxford
South Lodge
South Parks Road
Oxford
Tel:
LANDSCAPE ARCHITECT:
fira
Fira
The Jewellery Business Centre
95 Spencer Street
Birmingham, B18 6DA
Tel: 012 1523 1033

MEP and SPECIALISMS:
HOARE LEA (H)
Hoare Lea
35A Old Iron Works
Great Clarendon St
Oxford OX2 6AT
Tel: 018 6533 9908

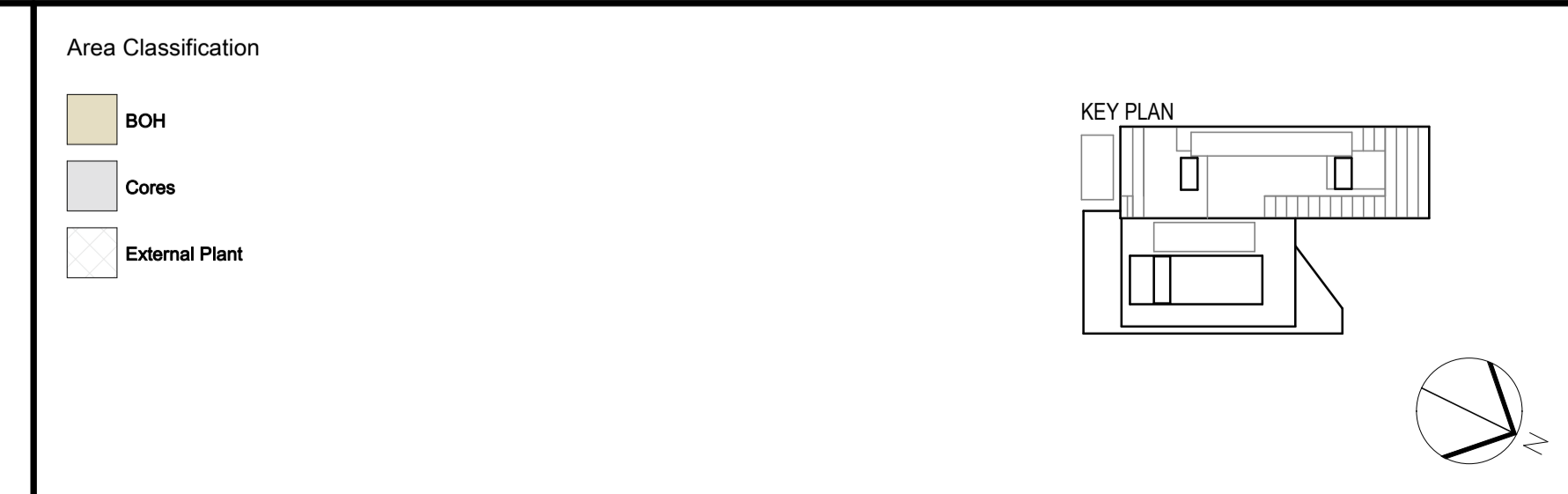

DRAWING ISSUE HISTORY:

REV	DATE	DESCRIPTION
C02	30 July 2021	CP Issue
C01	01 Apr 2021	Contract Issue - STAGE 4

GENERAL NOTES:

- DRAWINGS HAVE BEEN PREPARED ON AN ORIGINAL SHEET SIZE OF ISO A SERIES, A1 (841 x 594mm).
- HORIZONTAL DIMENSIONS SHOWN INDICATE FACE OF CONCRETE, FACE OF SHEATHING, CENTERLINE OF COLUMN GRIDLINE, OR FACE OF FINISH (INTERIOR), UNLESS OTHERWISE NOTED. VERTICAL DIMENSIONS INDICATE TOP OF SLAB, TOP OF SUBFLOOR, UNLESS OTHERWISE NOTED.
- THESE DRAWINGS ARE THE EXCLUSIVE PROPERTY OF NBBJ AND HAVE BEEN PREPARED FOR USE IN THE EXECUTION OF THE ENCLOSED PROJECT. USE OR REPRODUCTION FOR ANY OTHER PURPOSE WITHOUT THE WRITTEN PERMISSION OF NBBJ IS PROHIBITED.

PROJECT NAME:
Life and Mind Building (LaMB)

PROJECT NUMBER: 102601.00	STAGE: RIBA 4	
AUTHOR: JK	CHECKED: KD	APPROVED: JHe
SCALE: 1:200 @ A1	ISSUE DATE: 30 July 2021	
DRAWING NAME: GENERAL ARRANGEMENT PLAN - FIFTH FLOOR		
DRAWING NUMBER: 269-NBBJ-ZZ-05-DR-A-201005	ISSUE: A4 C02	